



City of Westminster



HANOVER  
SQUARE

# Hanover Square Public Realm Improvements

Public briefing - 18 July 2018

# Today's agenda

- Introduction
- Project Overview / Vision
- Approved Hard-Landscaping Scheme
- Build Programme
- Gardens Proposals
- Phased Delivery
- Access
- Keeping you updated
- Q&A



# The Vision

## **We are seeking to:**

- Transform the Square into a high quality public space
- Deliver enhanced public spaces and pedestrian areas
- Accommodate the significant increase in pedestrians expected with the opening of Crossrail's Bond Street station
- Introduce a modern and consistent lighting level
- Re-landscape the Gardens to create a tranquil oasis
- Provide an exceptional entrance into London's West End



## **Approved *Hard-Landscaping* Design**

Produced by WSP

Developed from Publica Concept.  
Design is subject to minor amendments and further consultation on the gardens

# Hard-Landscaping Scheme Details

- Improved highway layout around the Square including better quality pedestrian crossings at its junctions with connecting streets.
- Reallocation of parking and loading bays and controlled service vehicle access to Tenterden Street to help minimise pedestrian and traffic conflicts.
- Pedestrian only West Terrace on the Square, creating a large public space to meet, relax and orientate yourself.
- Introduction of new street lighting to modern standards.
- Wider footways to improve pedestrian movement.
- Continuous pedestrian accessible route around the edge of the Square.



# Public Realm Images



North-west corner of Hanover Square - Indicative images produced by WSP 2017

# Cabmen's Shelter Relocation



Indicative view from the western terrace of Hanover Square looking south

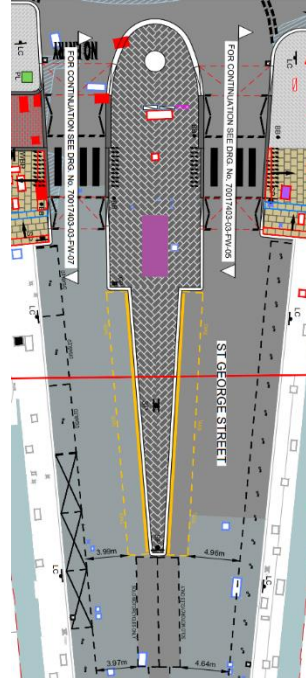

Indicative view from St George Street towards Hanover Square

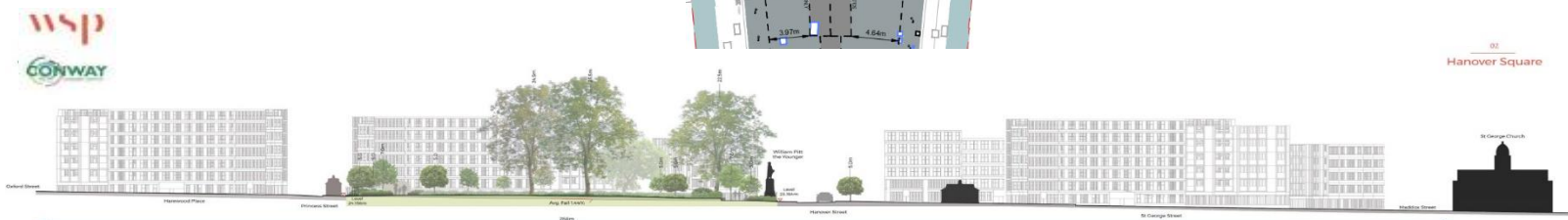

**Indicative Design**  
Images produced by WSP



# Garden Proposals

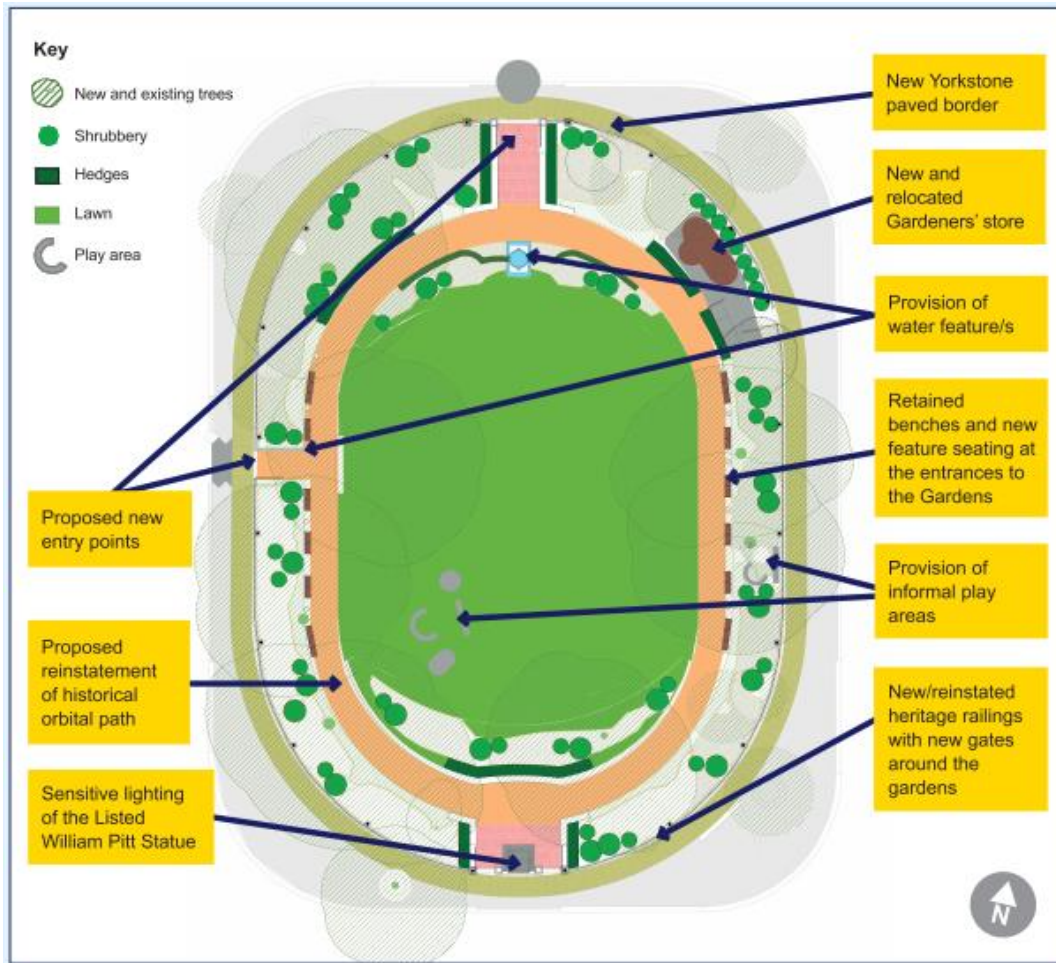

- Re-landscaped
- Orbital path
- Large oval lawn, new trees, new hedges, shrubbery
- Discourage cut-through
- New access gates
- Repositions benches
- Relocation of the water feature
- New Garden Store
- Improved play area

\*Subject to public consultation





City of Westminster

# The Build



HANOVER  
SQUARE

# Programme to date

Great Portland Estates / Publica - WCC / WSP and other key Stakeholders – FMConway delivery...

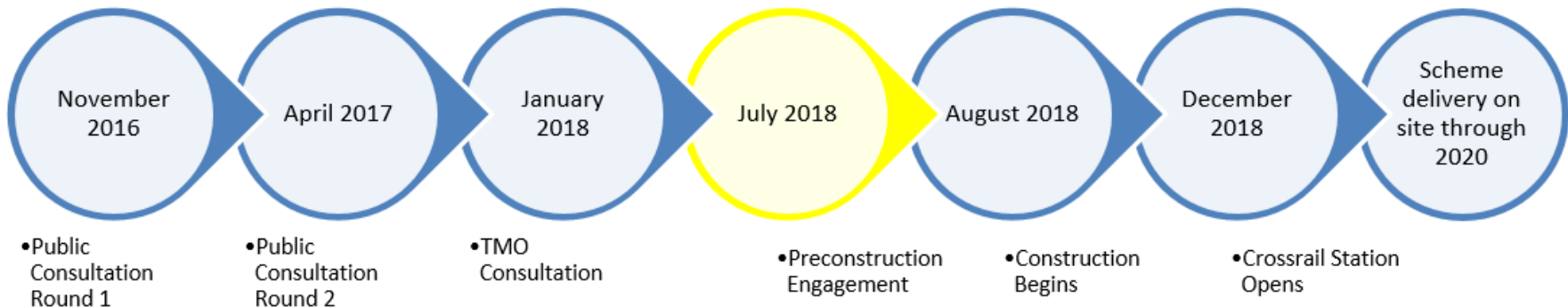

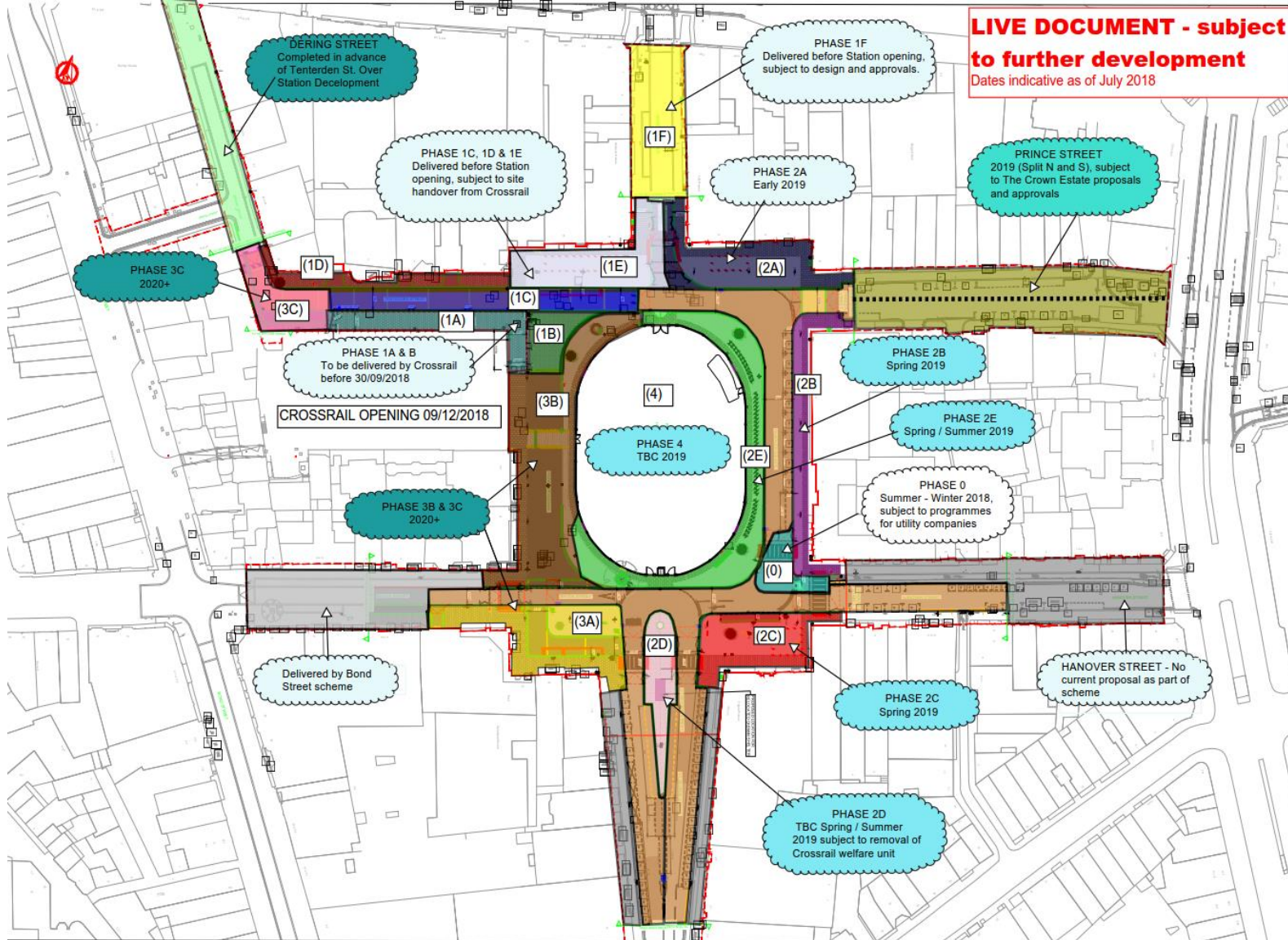

Indicative Phasing Plan as at July 2018  
Subject to live review

# Phase 0

- Summer 2018 – Winter 2018
- Utility company diversion works
- BT, Virgin Media and UK Power Networks
- Required for realigned carriageway and wider footways
- During works, some road closures and diversion routes put in place

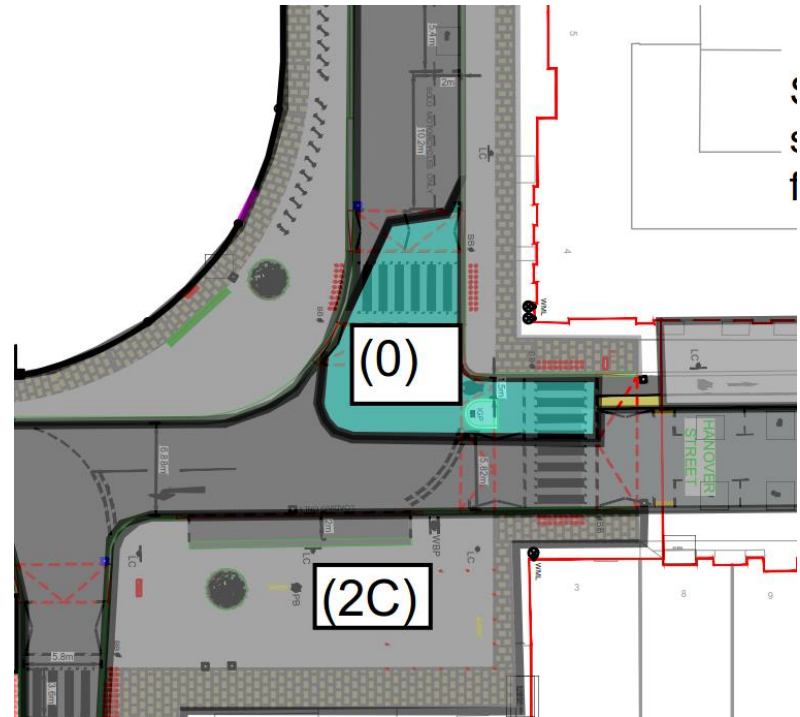



# Phase 1

- Autumn 2018 – Winter 2018
- Working with Crossrail around the station entrance
- Harewood Place pending discussions with TfL and necessary approvals
- Works within the existing Crossrail site
- Seeking to complete prior to Station opening in December 2018

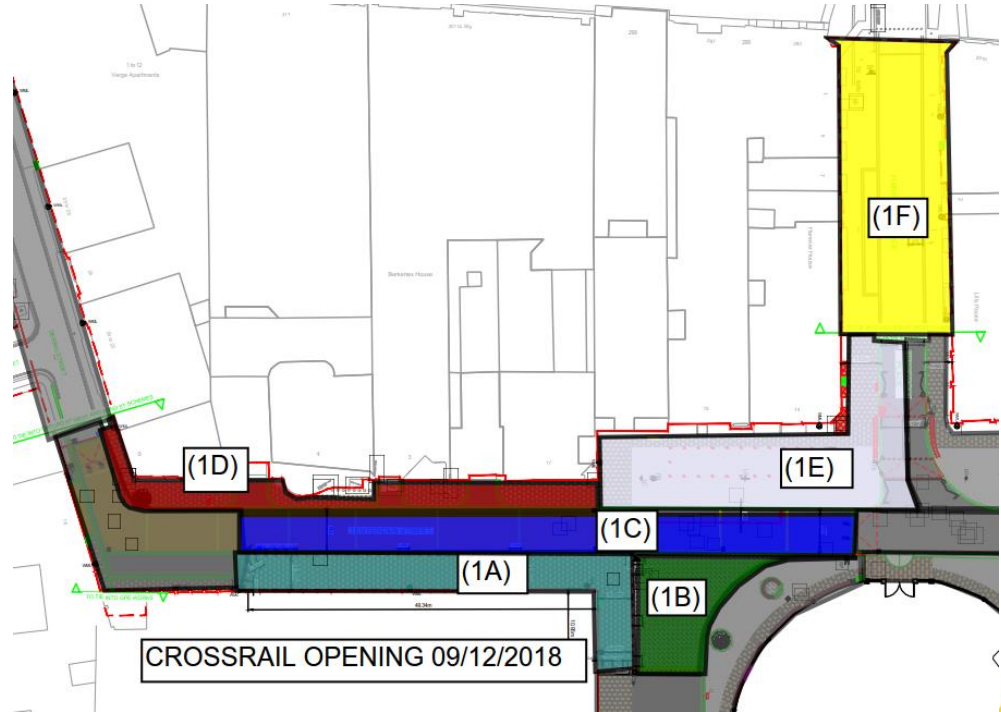

# Phase 2

- Spring 2019 – Summer 2019
- Continuation of footway improvements around the Square
- Relocation of the Cabmen's Shelter to St George Street
- Access to be maintained to properties
- Possible temporary road closures and diversion routes to be sign-posted

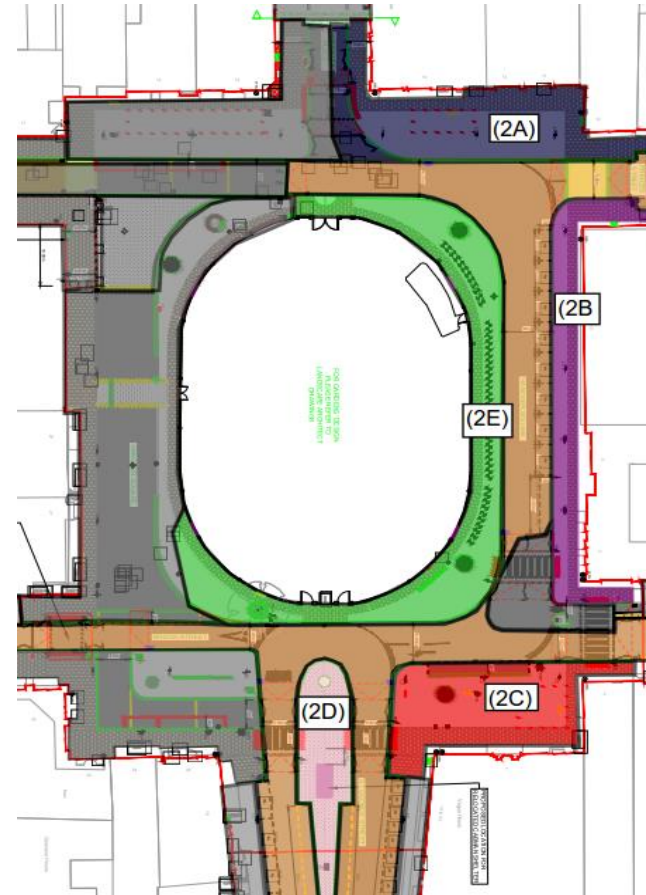

# Phase 3 and 4

- 2019 / 2020
- Hanover Square Gardens and railings pending further design and consultation
- Phase 3 to be completed following Great Portland Estates and 22 Hanover Square developments

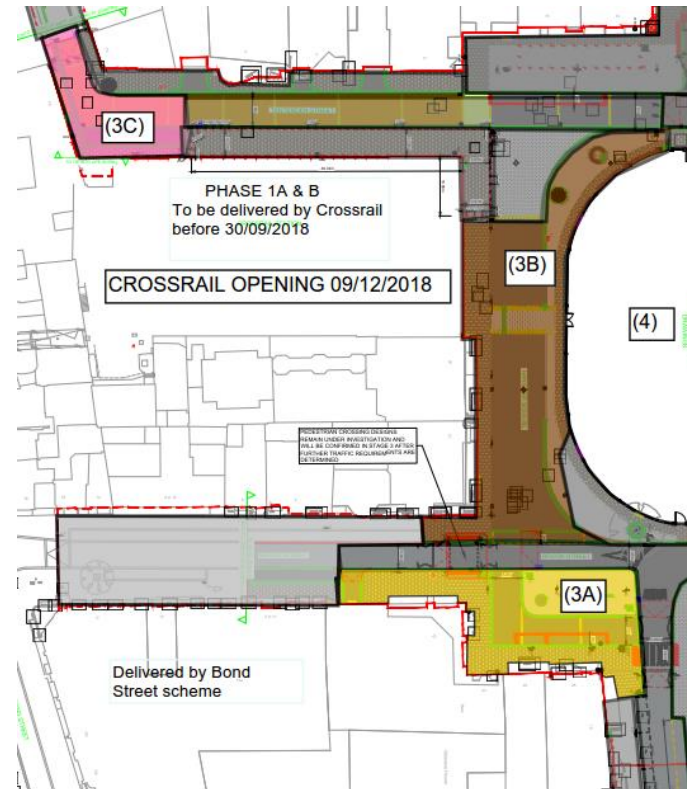

# Access during the works

- Pedestrian access to buildings and shops will be maintained at all times
- All traffic routes are subject to change and will be indicated by appropriate signage
- Access to some side roads may be impacted
- Parking and loading bays and cycle stands will be temporarily suspended when necessary, advanced notice will be provided





City of Westminster

Keeping you updated



HANOVER  
SQUARE

# Communicating with you

- Advanced notice of works
- Regular email updates to all those who have registered with us
- Hanover Square website:

[www.westminstertransportationservices.co.uk/hanover-sq](http://www.westminstertransportationservices.co.uk/hanover-sq)

- Dedicated email address - [hanoversquare@wsp.com](mailto:hanoversquare@wsp.com)

# Communicating with you

A4 Flyer delivered to all those who could be directly affected by the works

**PROPOSED CONSTRUCTION PHASES**

**HANOVER SQUARE**

**Hanover Square Public Realm Improvements**

Following Traffic Management Order Consultation in early 2018, Westminster City Council has completed the development of the design proposals for public realm improvements in Hanover Square.

The project will be delivered in phases to accommodate construction and operation of Crossrail's Bond Street Station Eastern Ticket Hall and other neighbouring developments. The station is due to open in the north-west corner of the Square in December 2018.

**Public Realm Vision**  
The vision for the Square is to:

- Transform the area into a high quality public space fitting of its heritage and future use.
- Deliver enhanced public spaces to accommodate the significant increase in pedestrians expected with the opening of the station.
- Provide an exceptional public space in the heart of central London and gateway to London's West End.

**Works**  
The City Council, as the highway authority, is leading on this project, working closely with key local stakeholders.

Works are due to start on site in summer 2018 (see Proposed Construction Phases map overleaf). Further information will be made available before each construction phase begins.

**Access**  
Pedestrian access to buildings and shops will be maintained at all times.

All traffic routes are subject to change, and will be indicated by appropriate signage.

Access to some side roads may be impacted and it is likely there will be a need to temporarily suspend parking and loading bays to enable works to progress.

**PHASES (P) PROGRAMME\***

Phase	2018	2019	2020
P0	Q1	Q2	Q3
P1	Q1	Q2	Q3
P2	Q1	Q2	Q3
P3	Q1	Q2	Q3
P4	Q1	Q2	Q3

\*Indicative June 2018

**CONTACT US**  
Register to receive HanoverSquare updates.

**FIND OUT MORE**  
Further information leaflets distributed through this scheme at Westminster. Visit [westminster.gov.uk/hanover-sq](http://westminster.gov.uk/hanover-sq)

Please visit the [westminster.gov.uk/hanover-sq](http://westminster.gov.uk/hanover-sq) website for more information.

Please join us on the **18 July 9:30am-12:30pm** to find out more about this scheme at **The Salvation Army, Regent Hall, 275 Oxford St, London W1C 2DJ**. A presentation will be given by the project team at 10:00am.

Summer 2018

City of Westminster

# Contact Us:

Contact us at:

[hanoversquare@wspgroup.com](mailto:hanoversquare@wspgroup.com)

**How useful did you find this event?** Provide us with feedback via our email address

More information at:

[www.westminstertransportationservices.co.uk/hanover-sq](http://www.westminstertransportationservices.co.uk/hanover-sq)



# Questions?



City of Westminster

Thank you



HANOVER  
SQUARE